

## F611 / F626

Semi-Lugged Lever Operated  
Butterfly Valves

F611

PN16

### Features & Benefits

- Robust, ductile iron valve body for long life service
- Valve body semi-lugged to fit PN16 or ANSI Class 125 flanges
- The anti-blow out stem design provides a safe and secure operation
- Integrated notch plate for a more compact design and aluminium lever to reduce risk of corrosion
- Fully bonded epoxy paint system for superior corrosion resistance
- Suitable for applications where Level 3 C3 (Medium) corrosion protection is required
- Maintenance free valve design, reducing downtime
- Suitable for a wide temperature range -10°C to 130°C



GENERAL VALVES

### Materials

PART	MATERIAL
Body	Ductile Iron ASTM A536 64-45-12 (Epoxy Paint)
Disc	Aluminium Bronze C954 ASTM B148
Liner (F611)	Nitrile Temp. -10 to 90°C
Liner (F626)	EPDM (High Temperature) Temp. -10 to 130°C
Shaft	Stainless Steel Type 410
Taper Pin	Stainless Steel Type 410
O-Ring	Buna-N
Bushing	PTFE
Lever	Aluminium Alloy (Epoxy Paint)

### Dimensional Drawing

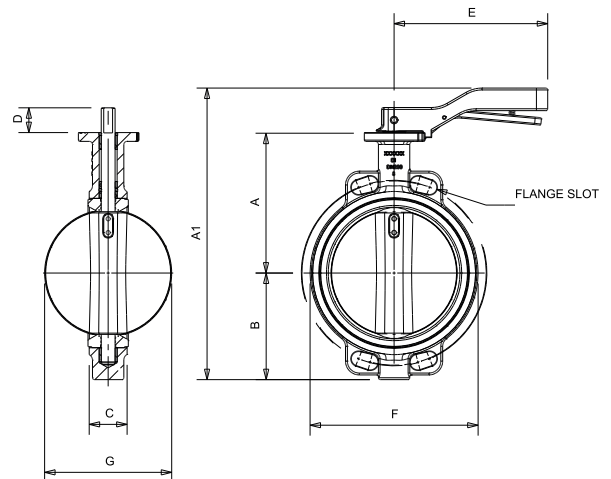

### Dimensions & Weights

SIZE (mm)	WEIGHT (kg)	A (mm)	A1 (mm)	B (mm)	C (mm)	D (mm)	E (mm)	F (mm)	G (mm)	Kv	FLANGE SLOTS TO SUIT
50	2.4	109	246	72	43	32	212.5	100	52.9	98	DN50 PN16 / 2" CL125
65	3.3	131.5	278.5	82	46	32	212.5	120	64.6	167	DN65 PN16 / 2.1/2" CL125
80	3.6	134	294	95	46	32	212.5	127	79	258	DN80 PN16 / 3" CL125
100	4.5	163	343	115	52	32	212.5	156	104.4	512	DN100 PN16 / 4" CL125
125	6.3	169	359	125	56	32	212.5	190	123.5	872	DN125 PN16 / 5" CL125
150	8.4	179	392	142	56	40	245	212	155.8	1,347	DN150 PN16 / 6" CL125
200	13.4	224	465	170	60	40	378	268	202.7	2,675	DN200 PN16 / 8" CL125

### Pressure/Temperature Ratings

	F611	F626
MAX TEMP (°C)	-10 to 90	-10 to 130
PRESSURE (BAR)	16	15.7

Intermediate pressure ratings shall be determined by interpolation.

\*Kv coefficient denotes valves in fully open position

**PRESSURE RATING:** PN16 / CLASS 125

**TEST PRESSURES:**

Shell: 24 Bar Seat: 17.6 Bar

**SPECIFICATION:** Lever operated epoxy coated Ductile Iron Body. Semi-lugged. Aluminium disc. EPDM or Nitrile liner. To suit flange connections BS EN 1092-2 PN10 or PN16 and ANSI B16.1 Class 125.

Valves may be used for flow regulation. Valve design conforms to BS EN 593.

Face to face conforms to BS EN 558.

**MEDIUM:**

F611 - Suitable for Group 1 and 2 gases and Group 1 and 2 liquids as defined by the Pressure Equipment Directive 2014/68/EU.\*

F626 - Suitable Group 2 liquids as defined by the Pressure Equipment Directive 2014/68/EU.\*

\* See page xxx for more information