

D151X

Bronze Gate Valve



PN25



Please note the photograph denotes sizes 1/2" - 2" only.

Features & Benefits

The D151X bronze gate valve offers a dependable and long service life across a wide variety of applications by virtue of its design and material composition.

- Non-rising stem design to minimise installation height
- Full bore design to ensure minimal pressure drop
- Adjustable gland packing for ease of maintenance
- Material selection results in superior dezincification (DZR) and corrosion resistance properties
- Body, bonnet and disc are made from low lead content bronze, typically 4-6%

Materials

PART	MATERIAL	SPECIFICATION	SIZES
Body	Bronze	BS EN 1982 (CC491K)	ALL
Bonnet	Bronze	BS EN 1982 (CC491K)	ALL
Stem	DZR Brass	BS EN 12164 CW602N	ALL
Disc	Bronze	BS EN 1982 (CC491K)	ALL
Stem Retainer	DZR Brass	BS EN 12164 CW602N	1/2 - 2
Stuffing Box	DZR Brass	BS EN 12164 CW602N	1/4 - 3/8, 2 1/2 - 3
Packing Ring	PTFE	-	ALL
Packing Nut	Brass	BS EN 12164 CW614N	ALL
Packing Gland	Brass	BS EN 12164 CW614N	1/4, 3/8, 1 - 3
Handwheel	Aluminium	-	ALL
Identification Plate	Aluminium	-	ALL
Handwheel Nut	Brass	BS EN 12164 CW614N	ALL
Gasket	Asbestos Free	-	3

Dimensional Drawing

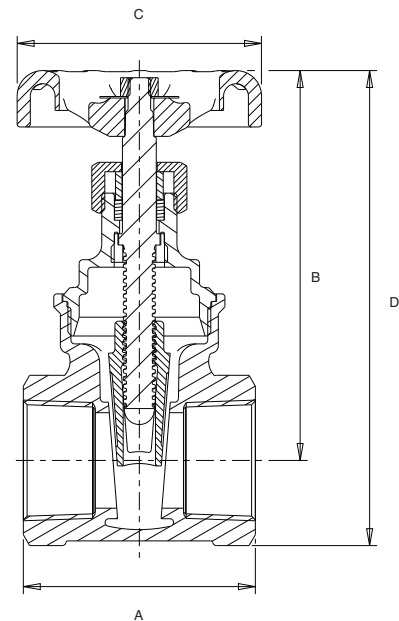

Dimensions & Weights

SIZE (inch)	A (mm)	B (mm)	C (mm)	D (mm)	WEIGHT (kg)	KV
1/4	46	75	45	86.7	0.27	-
3/8	46	75	45	86.7	0.26	-
1/2	50	78	52.3	93.0	0.27	21
3/4	54	84	60	103	0.38	39
1	62	105	65	127	0.59	66
1 1/4	71	111	70	139	0.89	116
1 1/2	77.5	130	78	163	1.31	162
2	87.5	153	92	193	2.09	281
2 1/2	106	235	103	286.2	5.62	411
3	113	251	121	310.3	7.89	635

Pressure/Temperature Ratings

TEMPERATURE (°C)	-10 to 66	120	170	186
PRESSURE (BAR)	25.0	21.8	12.8	10.5

Intermediate pressure ratings shall be determined by interpolation.

PRESSURE RATING: PN25

TEMPERATURE OPERATING RANGE: -10 to 186°C

UK END CONNECTION: Taper threaded to BS EN 10226-2 (ISO 7-1) formerly BS 21

US END CONNECTION: ANSI B1.20.1

OPERATOR: Handwheel.

Gate valves are best for services that require infrequent valve operation, and where the disc is kept either fully opened or fully closed. They are not practical for throttling.

SPECIFICATION: The valve body, bonnet and disc shall be of Bronze to BS EN 1982 CC491K. The stem shall be of DZR Brass to BS EN 12164 CW602N. Operation shall be by hand wheel. Ends to be threaded to BS EN 10226-2. The valve is to be rated at PN25 and manufactured in accordance with BS EN 12288: 2010.

The Non-Rising Stem Gate Valves are unsuitable for use on Group 1 gases or unstable fluids, as defined by the Pressure Equipment Directive 97/23/EC and Article 13 of 2014/68/EU.

Every effort has been made to ensure that the information contained in this publication is accurate at the time of publishing. Crane Ltd assumes no responsibility or liability for typographical errors or omissions or for any misinterpretation of the information within the publication and reserves the right to change without notice.

Valid as of 030117