

## FM276 DN250 - DN600 PN16

## F277 DN250 - DN300 Class 125

### Ductile Iron Strainer

#### Features & Benefits

- Scale and dirt in piping systems causes endless trouble and frequently serious damage to pipeline equipment.
- Installation of Crane strainers will help eliminate the problems caused by foreign matter within piping systems
- The FM276 offers the integrity of manufacture, quality and reliability which are the hallmarks of all Crane products
- Cap tapped and plugged for drain
- Stainless Steel strainer element

#### Materials

PART	MATERIAL	SIZE
Body	Ductile Iron A536 65-45-12 (EN-GJS-450-10)	250-500
Body	Ductile Iron BS EN 1563 (EN-GJS-500-7)	600
Cap	Ductile Iron A536 65-45-12 (EN-GJS-450-10)	250-500
Cap	Ductile Iron BS EN 1563 (EN-GJS-500-7)	600
Gasket	Asbestos Free	All
Screen	Stainless Steel AISI Type 304	All
Drain Plug	Malleable Iron	All
Test Point Plug Rc 1/4	Malleable Iron	All
Studs	Steel Grade 8.8	250-300
Nuts	Steel Grade 8	250-300
Bolts	Carbon Steel Grade 4.6	350-500
Bolts	Carbon Steel Grade 4.8	600

#### Dimensions & Weights

SIZE (mm)	WEIGHT (kg)	A (mm)	B (mm)	C (mm)	D (Rc)	kV
250	266	686	534	788	2"	1470
300	397	757	624	928	2"	2151
350	328	848	680	1015	2"	3018
400	452	984	765	1135	2"	4138
450	627	1105	845	1250	2"	5233
500	751	1257	997	1605	2"	6810
600	1080	1450	1160	1655	2"	8180

**PRESSURE RATING:** FM276: PN16 / F277: Class 125

**TEMPERATURE OPERATING RANGE:**

FM276: -10 to 200°C

F277: -10 to 230°C

**UK END CONNECTION:** Flanged BS EN 1092-2: PN16

**US END CONNECTION:** Flanged Class 125 BS1560

- section 3.2 / ANSI B16.1 Flat Face

**SPECIFICATION:**

Strainers are supplied with a stainless steel perforated strainer element. The mesh screen diameter hole sizes are as follows: DN250 - DN300 1.5mm diameter, DN350-DN500 3.2mm diameter and DN600 3.0mm diameter.

This product is suitable for use on Group 2 liquids only, as defined by the Pressure Equipment Directive 97/23/EC and Article 13 of 2014/68/EU.\*

Bosses drilled, tapped and plugged.

\* See page 251 for more information



#### Dimensional Drawing

Drawing depicts to sizes DN350-600 with bolts

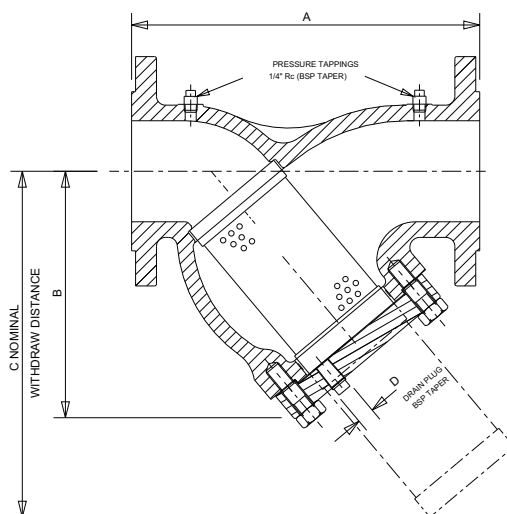

#### Pressure/Temperature Ratings - FM276

TEMPERATURE (°C)	-10 to 120	200
PRESSURE (BAR)	16	12.8

#### - F277

TEMPERATURE (°C)	-10 to 65	230
PRESSURE (BAR)	13.8	8.6

Intermediate pressure ratings shall be determined by interpolation.